

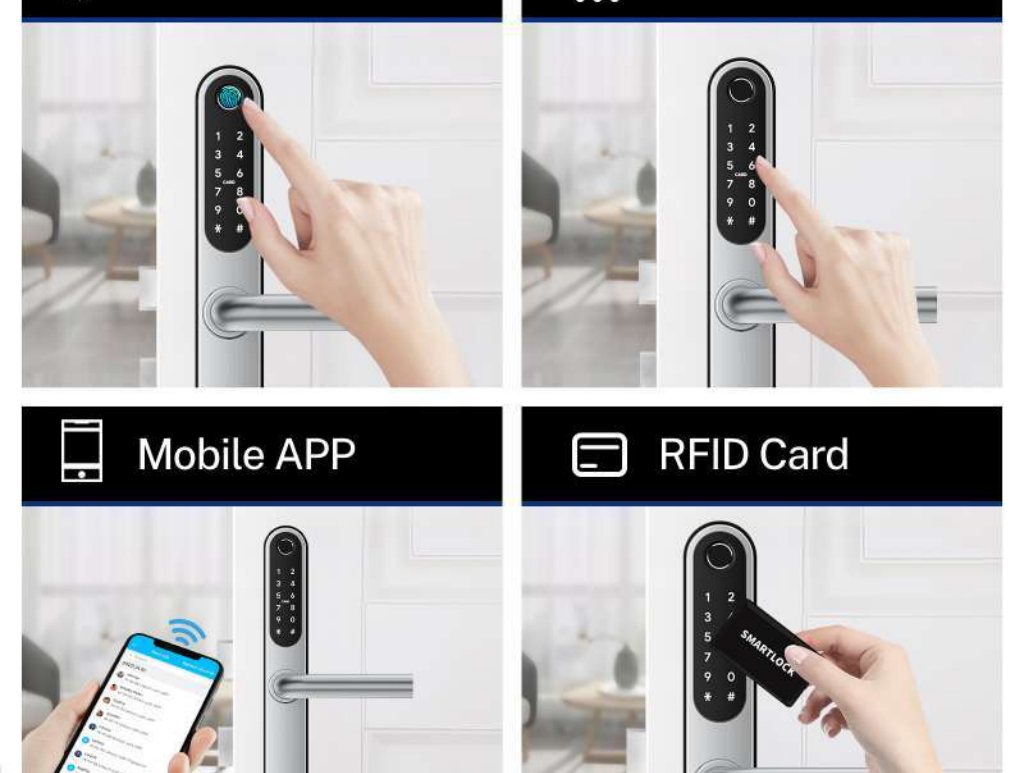

- BLE
- Fingerprint
- Password
- CARD
- Mechanical Key
- APP
- Remote Control



Before - only key unlock



Mobile APP / Fingerprint / Card unlock / WiFi unlock  
Pin code unlock / Mechanical key unlock

### DIY INSTALLATION

EASY TO INSTALL WITH 1 SCREWDRIVER AND 2 SCREWS.



### MULTIPLE WAYS TO UNLOCK

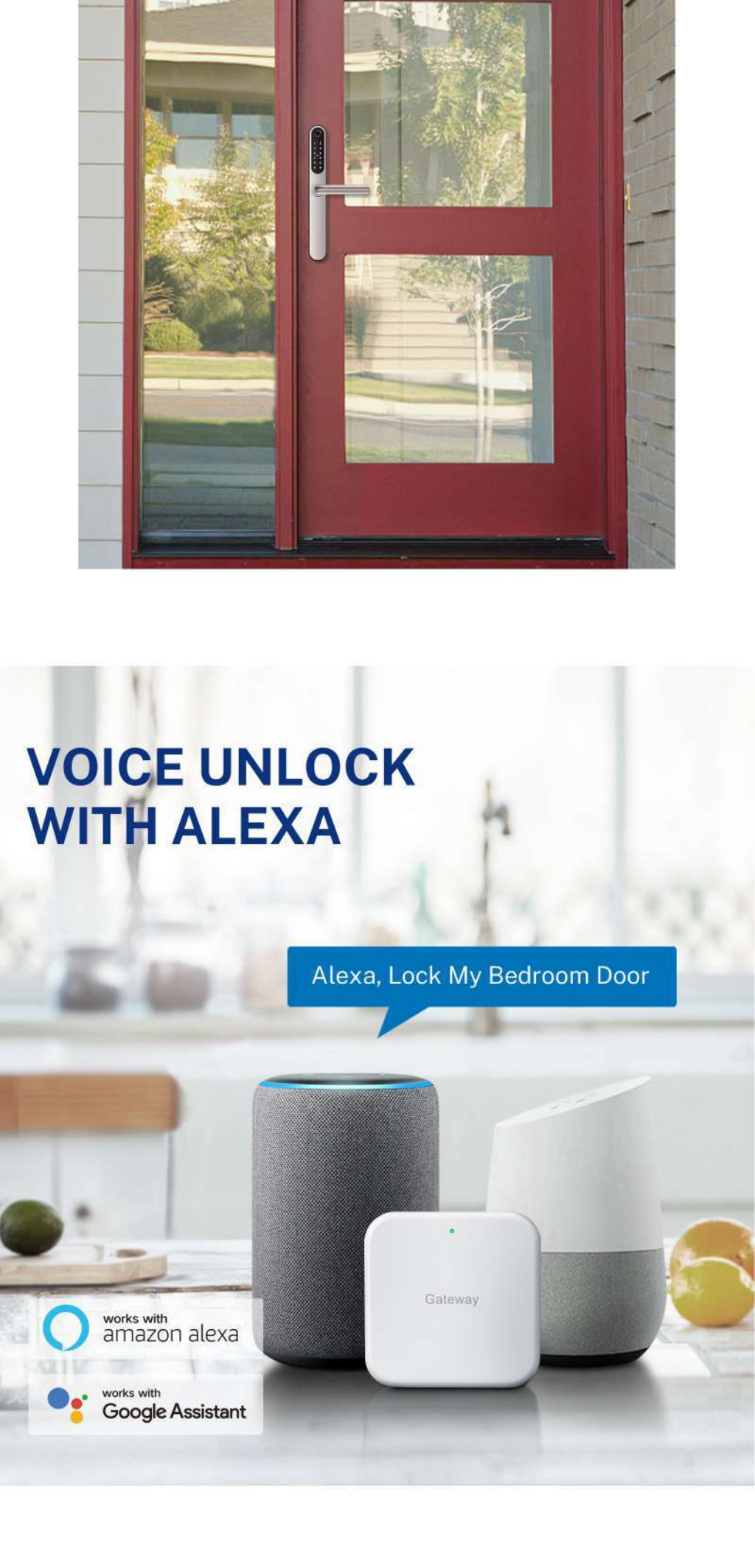

- 0 - 95% Working Humidity
- 35°C ~ 55°C Working Temperature
- 6V/4x AA Batteries Working Voltage
- Less than 4.8V Low Wattage Alarm

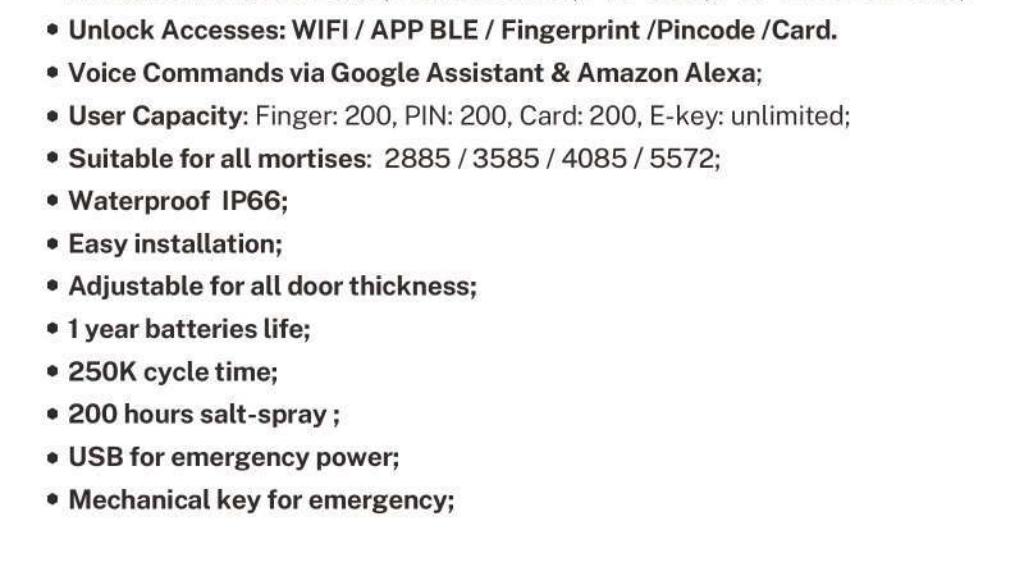

### VOICE UNLOCK WITH ALEXA

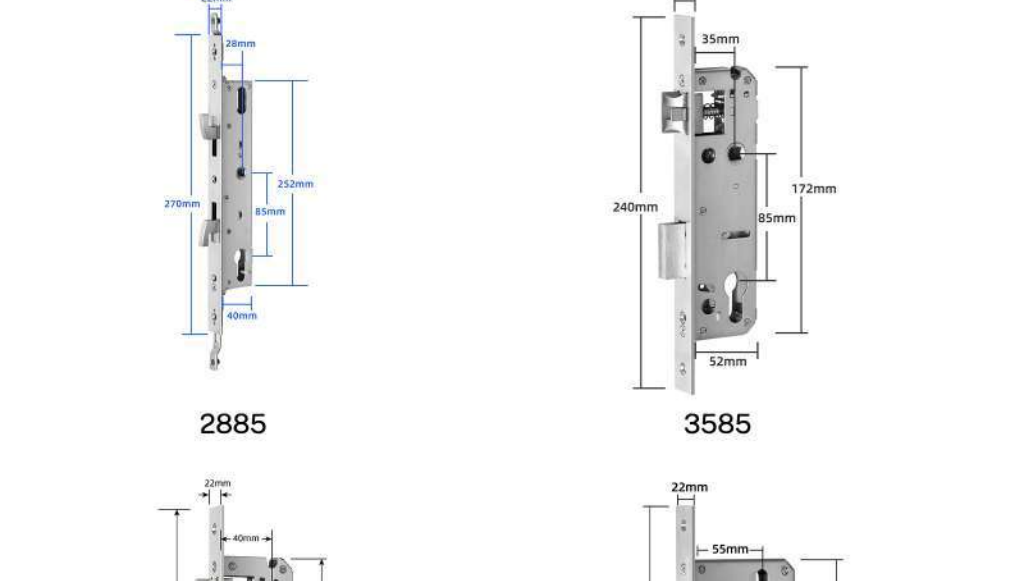

### SMART HANDLE LOCK S2

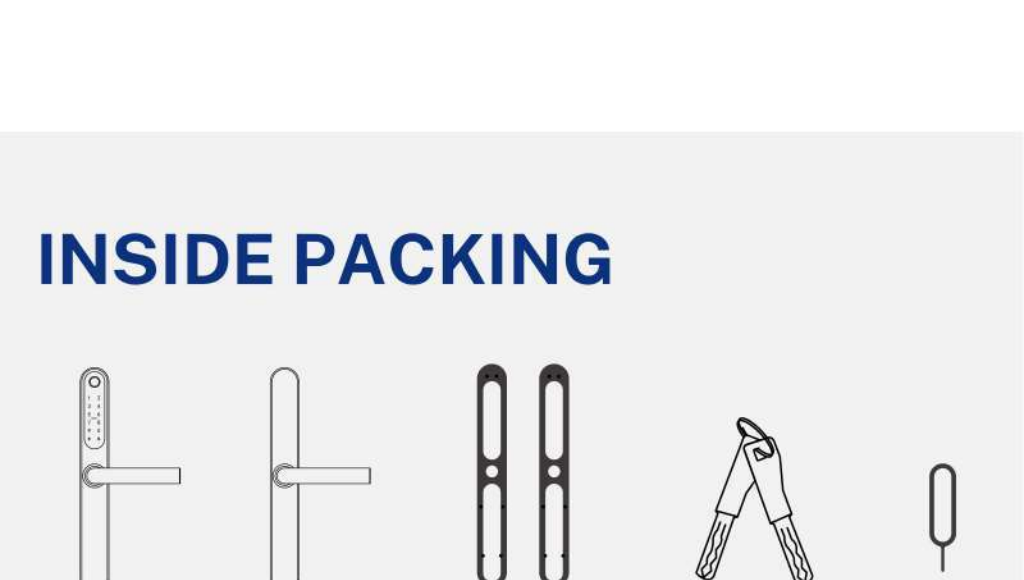

#### Features

- Lock Dimension: 310mm(D)\*41mm(L)\*23mm(H);
- Available in Matted Black, Hairline Silver, PVD Gold, PVD Mirror Chrome;
- Unlock Accesses: WIFI / APP BLE / Fingerprint / Pincode / Card.
- User Capacity: Finger: 200, PIN: 200, Card: 200, E-key: unlimited;
- Suitable for all mortises: 2885 / 3585 / 4085 / 5572;
- Waterproof IP66;
- Easy installation;
- Adjustable for all door thickness;
- 1 year batteries life;
- 250K cycle time;
- 200 hours salt-spray;
- USB for emergency power;
- Mechanical key for emergency;

### SUITABLE FOR BELOW LOCK BODY

2885/3585/4085/5572



### INSIDE PACKING



### OEM BRANDING

OEM BRANDING IN FOLLOWING POSITION.



www.ics.gr